

TITAN STAINLESS CUSTOM FOODSERVICE FABRICATION

502 Usher Street Pageland, SC 704 243 8717 www.titanstainless.com



WALL CABINET WITH HINGED DOORS

TITAN STAINLESS Wall cabinets are made using all-welded heavy gauge stainless steel construction. The tops of the cabinets are sloped to prevent dust from settling, facilitating a cleaner environment. Tops are formed from one piece, and bolted to cabinet walls below. Cabinet walls are faced with 2" wide mullions, and base shelves and mid-shelves are welded between and reinforced as necessary. Doors with recessed pulls are mounted on stainless steel flag hinges, and can be removed. Cabinets are mounted to walls using heavy gauge stainless "Z" clips. All welds are ground and polished to a smooth finish.

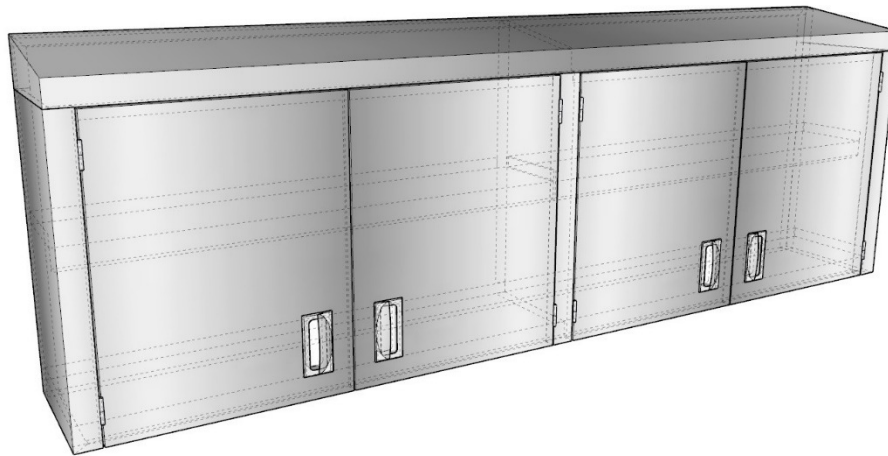

MODEL NUMBER SELECTION / INFORMATION

(Example #: 6SWCD-12)

Wall cabinets are available in standard lengths from 4'-0" to 12'-0", in 1-foot increments. Standard widths (front-to-back) are available in 12" and 18". Units over 6'-0" long will be furnished with an additional cabinet wall at the center—doors are added evenly as required.

- See **AutoQuotes™** for full list of model numbers and pricing, along with all additional accessories
- Custom sizes and configurations are available upon request

